

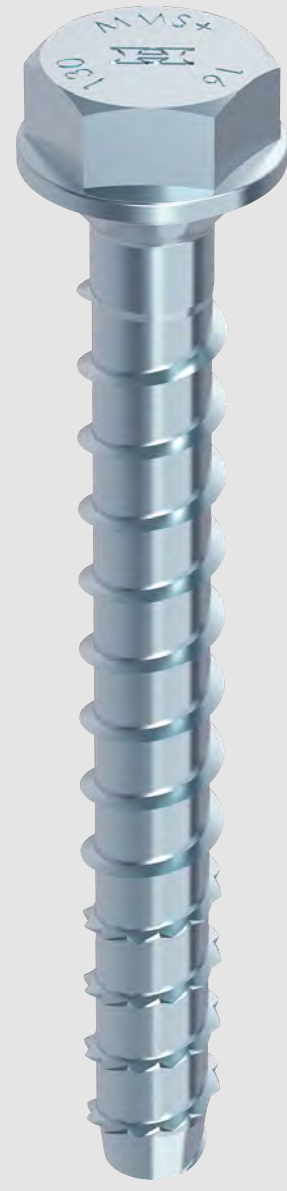

# Concrete screw 16 x 130

PRODUCT INFORMATION

**NEW**  
in the range



# Concrete screw 16 x 130

## Screw anchor for the assembly of adjustable props

Thanks to the optimised concrete thread and an extremely adaptable cone under the head, the concrete screw 16 x 130 is ideally suited for the temporary fixing of construction site equipment such as slab props, push-pull props, fall protection or scaffolding in concrete and formwork construction.

### Benefits

- For temporary fastening of construction site equipment
- Dismountable and reusable
- Ideal core/thread geometry makes it easy to screw in and has high admissible capacities
- Toothed functional tip reduces wear

### User-friendly assembly

The innovative screw anchor is very easy to install and reduces the risk of errors, as it requires no dowels and is screwed directly into the pre-drilled concrete surface. The concrete screw can also be dismantled at any time and reused several times. The test sleeve enables easy testing of the concrete screw to ensure that it can be safely reused.

### Optimised concrete thread with large surface area

Thanks to reinforced tothing on the bolt tip, the concrete screw is easy to set and it is also less susceptible to wear and tear. The higher outer diameter at the tip and the load-bearing thread ensures an optimal undercut in the concrete and thus allows higher loads.

The integrated cone under the head adapts to different hole diameters.

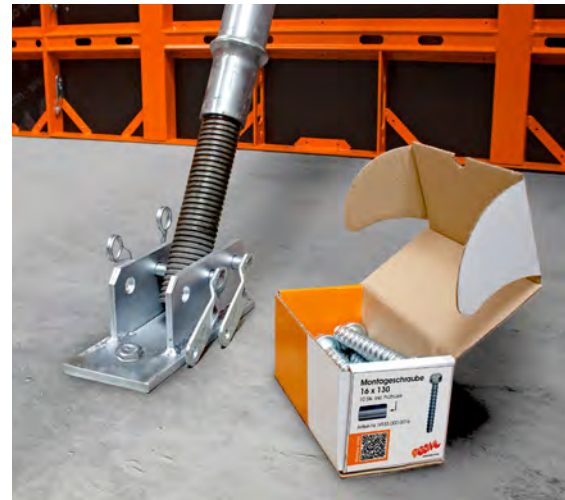
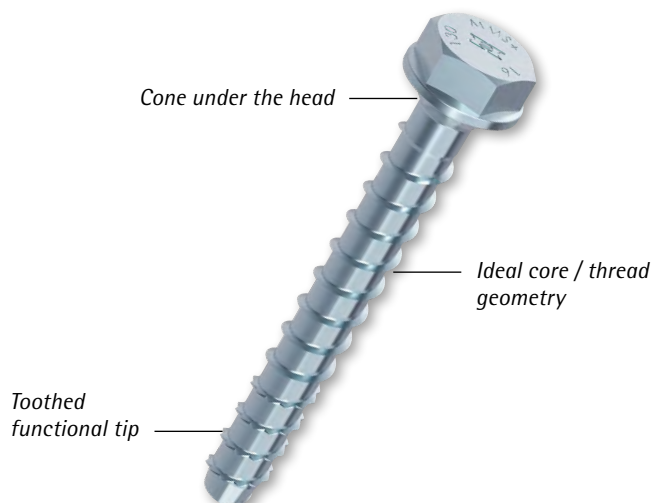

The concrete screw can be screwed into the concrete surface without any difficulty.



When used for temporary fixings, the included test sleeve can be used to check whether the concrete screw can be reused at any time.